

Crystalbrook Retreat

Exceptional and unique
Whitsunday acreage.

Position, Position, Position.

You will want to fully immerse yourself into your own special haven at Crystalbrook Retreat, the first subdivision in Crystalbrook for 30 years. This new estate is uniquely located nestled into the Clarke ranges opposite Camp Kanga, 1 km to Peter Faust Dam and Lake Proserpine. Crystalbrook Retreat is the closest neighbor to this deep, rich Lake which is the largest body of fresh water in the area famous for prime Barramundi and red claw fishing as well as aquatic water sports. How rich would your life be living on your **large attractive 5 to 15 acre lifestyle allotments** secluded amongst the soothing sounds of brilliantly colored native birdlife? Surround yourself with abundant native wildlife including the endangered Proserpine Rock Wallaby and low maintenance, naturally created vegetation.

These natural wonder allotments have **easy access to the Whitsunday Coast**. A short 12 minute drive along two lane bitumen road parallel to the picturesque Proserpine River accesses Proserpine's top grade hospital for the district, doctors, chemist, shopping centres, Private and State Primary and High Schools, Golf Course, Entertainment Centre and Sporting venues. The free school bus picks up and delivers children home to and from Proserpine. Facilities include weekly garbage services, power, phone and internet available to the estate.

Invest in your exceptional Whitsunday lifestyle experience in a **safe neighbourhood**, bordered by native bushland, the Clarke Ranges and a select few neighboring homesteads escaping to your own unique and remarkable acreage.

You will make the perfect choice for your dream home from nine allotments including several with stunning **elevated views** of the Proserpine River Valley and Crystalbrook Valley. One 10 acre allotment has 180 degree extensive magnificent sea views overlooking Cape Gloucester and the mouth of the Proserpine River and Cape Conway. Nature specifically designed and landscaped the individual, distinctive allotments including rainforest, breathtaking hill top views, woodland, bush land, seasonal watercourses and open areas including areas for tennis courts, swimming pools and house sites.



Crystalbrook Retreat
PO Box 705
Proserpine QLD 4800

P. 07 49472 552 +61 7 49472552
F. 07 49472700
M. 0419 717 053 Noel Allan
M. 0429 055 164 Marilyn Allan
E. marilynallan@gmail.com
W. www.crystalbrookretreat.com

Crystalbrook Retreat



- ✓ Family Fun, horse riding, cricket, football, tennis, swimming pool, bushwalking.
- ✓ Fishing for Barramundi and red claw one klm away, also aquatic water sports.
- ✓ Feel the fragrant fresh air on your face, run your fingers through the untouched rich virgin fertile black soil and grow your own organic vegetables and orchard or a further habitat for wildlife.
- ✓ Fantastic value, large allotments, investment in environmentally important area.
- ✓ Easy Access to Whitsunday area.
- ✓ Flocks of native birdlife Rainbow Lorikeets, Kingfishers, Kookaburras, Parrots, Honeyeaters & Rosellas inhabit the wildlife refuges alongside Butterflies, Lizards, Possums, Gliders and endangered Proserpine Rock Wallaby.
- ✓ Lightly timbered with Moreton Bay Ash, Ironbark, Bloodwood & Gums.
- ✓ Seasonal natural watercourses and flowing streams.
- ✓ Treat yourself. Crystalbrook Retreat promises a fulfilling experience like no other, on large allotments away from the outside world. Feel like you are permanently on holiday. You deserve it!

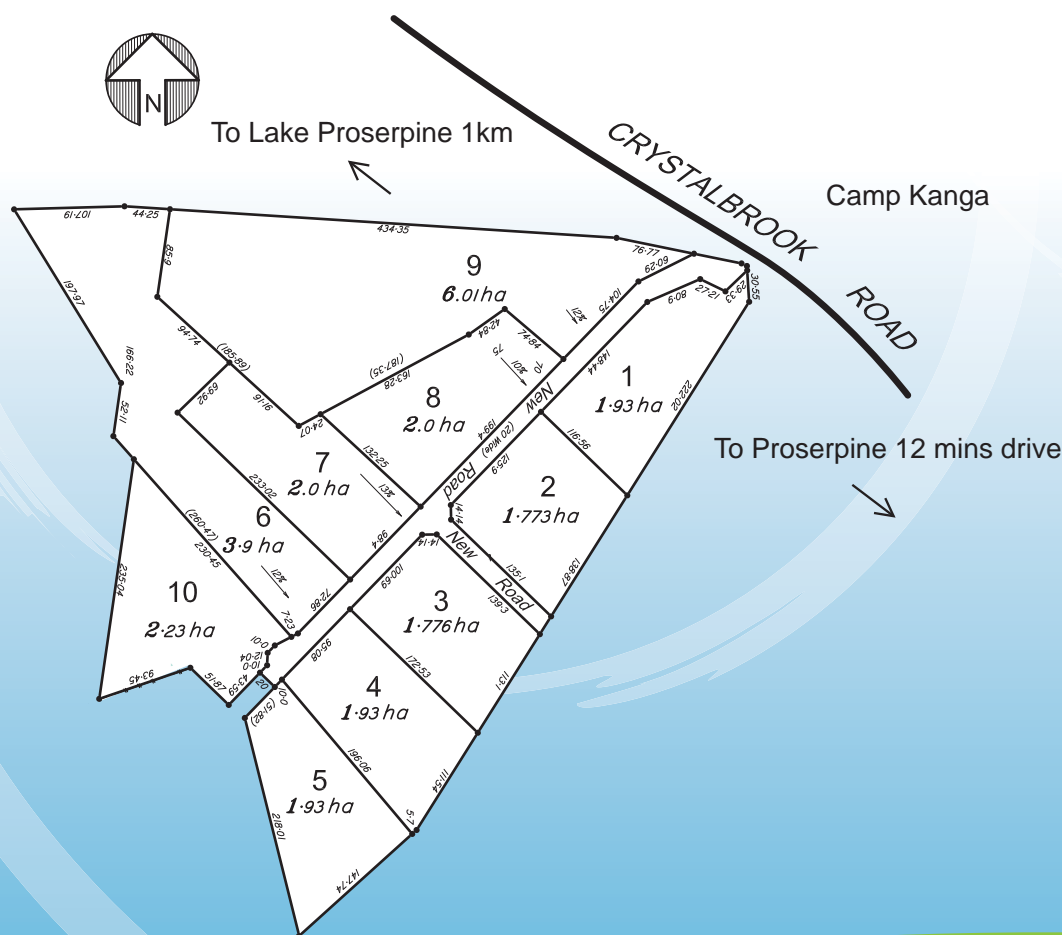

**First 2 Buyers
receive a
FREE watertank**



For every block sold 100 trees will be planted nearby to regenerate local habitat.